



# LAND CLEARING ATTACHMENTS





# WHY CHOOSE SHEAREX?

Choosing Shearex means investing in equipment designed to last and perform in the most demanding conditions. Our mulchers feature a G2.0-balanced rotor, Hardox® 500 in critical wear areas, and patented Convex DX protection for increased reliability.

Each machine is delivered job-ready, and—on VM models—with a standard hydraulic door. Start up is included in most of our mulchers. Add to that an innovative oil cooling system, fast access to wear parts in Canada, and on-site technical support. Get solutions built to maximize efficiency, longevity, and uptime.







## MULCHERS

6	Front Mount Bite Limiter Mulcher
8	Solid Drum Mulcher
10	Excavator Bite Limiter Mulcher
12	Excavator Light Duty Bite Limiter Mulcher
14	Startup Service
14	Customer Kit
15	Blade Types

## LAND CLEARING ATTACHMENTS

18	Harvester Shear
19	Stump Shear
20	Brush Grapple
21	Stump Grinder
22	Mini Tree Shear
22	Wood Cone Splitter

Shearex is part of GRYB International, a group of companies offering attachment solutions in the material handling, forestry & land clearing, steel production & distribution, construction, and ag & light industrial industries.

**GRYB****FORESTRY & LAND CLEARING**

Shearex's products are part of the GRYB Forestry & Land Clearing division. Our solutions optimize your operations, setting the industry standards for performance and reliability. Engineered with precision and durability, they ensure efficient land management with optimal results.







A white mulcher machine is shown in a wooded area, partially obscured by trees. In the foreground, a large pile of mulched branches and debris is visible on the ground. The machine's arm and cutting head are visible, and it appears to be in the process of mulching. The background is filled with green foliage and tree trunks.

# MULCHERS





## FRONT MOUNT **BITE LIMITER MULCHER**

### **HM SERIES**

Shearex's HM bite limiter mulcher is the the ultimate attachment for fast, efficient roadside maintenance, invasive species removal, land clearing, and underbrush maintenance. Offers the speed and power to complete any land-clearing job.

### **G2.0 BALANCING STANDARD ZERO VIBRATION ROTOR**

We are the only mulcher manufacturer to adhere to the highest vibration standards in the market, the G2.0 Balancing quality. Optimal balance is crucial to minimize vibrations, premature bearing wear, and structural fatigue.



### **BLADE ANGLE OPTIMISED FOR A PERFECT CUT AND LONGER OPERATION**

Our blade mount design provides greater durability and cutting power. The rotor maintains its power throughout the tooth life.



### **HYDRAULIC PUSH BAR**

The hydraulic push bar is a convenient piece of equipment that allows the alignment and control of materials during mulching operations.

Reliable and robust, it has been built for heavy duty operations for all the SV models of HM series.



### **PROTECTION SYSTEM CONVEX DX™**

Through our patented rotor configuration, the depth limiting rings are welded to both sides of the tooth holder, greatly increasing holder strength and durability. The rings force the material toward the center of the blade instead of just the edges, reducing blade wear and increasing blade longevity.



#### **IDEAL FOR**

LAND-CLEARING AND FORESTRY CONTRACTORS, MUNICIPALITIES, AND UTILITY SERVICES / HYDRO / ROAD MAINTENANCE



**High visibility.**

**Bolt-on liner and skid shoes made of Hardox® 500 for ultimate wear resistance. Easy maintenance or replacement.**

**Closer center of gravity for better handling.**

**Robust rotor design.**

**Poly-Chain® Carbon transmission belt.**

**High torque variable and adjustable motor.**

**Up to 100 inches cutting width.**

**Innovative oil cooling system: Cools the oil when the machine is idling, resulting in a temperature reduction of 30 to 50°F.**

		HM-60SR	HM-60DR	HM-70SR	HM-70DR	HM-70SV	HM-88LV	HM-90SV	HM-100SV2
<b>Recommended Minimum Carrier Power</b>	HP (KW)	68 (50)	68 (50)	74 (55)	74 (55)	125 (95)	140 (104)	170 (127)	250 (190)
<b>Cutting Width</b>	IN (CM)	59 (149)	59 (149)	75 (190)	75 (190)	75 (190)	87 (220)	91 (230)	100 (254)
<b>Cutting Dist. from Ground Level</b>	IN (CM)	0.4 (1)	0.4 (1)	0.4 (1)	0.4 (1)	0.4 (1)	0.4 (1)	0.4 (1)	0.4 (1)
<b>Number of Blades on Rotor</b>		21	21	27	27	24	28	33	36
<b>Optimal Target Material Diameter</b>	IN (CM)	6 (15)	6 (15)	8 (20)	8 (20)	10 (25)	10 (25)	15 (40)	24 (60)
<b>Exterior Length</b>	IN (CM)	49.25 (125)	48 (122)	49.25 (125)	48 (122)	48.75 (124)	50 (126)	47 (118)	47 (118)
<b>Exterior Height</b>	IN (CM)	51 (129)	57 (145)	51 (129)	57 (145)	59 (150)	59 (150)	53 (134)	59 (150)
<b>Exterior Width</b>	IN (CM)	72 (183)	72 (183)	89 (226)	89 (226)	90 (228.25)	102 (259)	106 (269)	118 (300)
<b>Rotor Diameter</b>	IN (CM)	17.625 (45)	17.625 (45)	17.625 (45)	17.625 (45)	20 (50)	20 (50)	20 (50)	20 (50)
<b>Approximate Typical Weight</b>	LBS (KG)	2,300 (1,043)	2,450 (1,113)	3,000 (1,361)	3,285 (1,490)	3,640 (1,655)	3,880 (1,760)	4,272 (1,938)	5,094 (2,311)

## HYDRAULICS

<b>Variable Displacement Axial Piston Motor</b>	CC	80	80	110	110	160	160	160	2x160
<b>Min. Required Continuous Flow</b>	GAL/MIN (L/MIN)	23 (87)	23 (87)	33 (125)	33 (125)	47 (178)	47 (178)	47 (178)	95 (360) for 160cc 70 (265) for 110cc
<b>Max Required Continuous Flow</b>	GAL/MIN (L/MIN)	42 (159)	42 (159)	54 (204)	54 (204)	76 (288)	76 (288)	76 (288)	150 (568)
<b>Max. Operating Pressure</b>	PSI (BAR)	6,000 (410)	6,000 (410)	6,000 (410)	6,000 (410)	6,000 (410)	6,000 (410)	6,000 (410)	6,000 (410)
<b>Rotating Speed</b>	RPM	2,600	2,600	2,600	2,600	2,500	2,500	2,300	2,300

## FEATURES

<b>Hydraulic Push Bar</b>	N/A	N/A	N/A	N/A	Optional	N/A	Optional	Optional
<b>Door</b>	N/A	Included	N/A	Included	N/A	N/A	N/A	N/A
<b>Hydraulic Motor Option</b>	N/A	N/A	N/A	N/A	N/A	N/A	N/A	2 x 110cc

This information is subject to change without notice.





## FRONT MOUNT **SOLID DRUM MULCHER**

### **HD SERIES**

Shearex's HD solid drum mulcher is ideal for operation in loam, clay and rocky soils, you can easily push through dense vegetation.

With double carbide teeth, counter blades and Hardox® 500 bolt-on liner and skid shoes, the HD Solid Drum provides increased efficiency and durability. Take your land clearing capabilities to the next level with the unmatched performance of Shearex's solid drum mulcher.

### **G2.0 BALANCING STANDARD ZERO VIBRATION ROTOR**

We are the only mulcher manufacturer to adhere to the highest vibration standards in the market, the G2.0 Balancing quality. Optimal balance is crucial to minimize vibrations, premature bearing wear, and structural fatigue.

The HD series mulcher is comprised of double carbide hammers and high-resistance carbide hammers on both ends for optimal durability and performance. Cutting edge counter blades provide maximum mulching efficiency and quality. Bolt-on inner blades for easy maintenance and optimized uptime.



**STANDARD & HIGH RESISTANCE**

**IDEAL FOR**

ROCKY GROUND CONDITIONS, OFFERING SIMPLE OPERATION AND MINIMAL MAINTENANCE





**Robust rotor design.**

**Hardox® 500 liner and skid shoes for maximum wear resistance.**

**Bolt-on and welded liner for simplified maintenance.**

**High visibility.**

**Poly-Chain® Carbon transmission belt.**

**Fastest rotor recovery.**

**Unique hose guard to avoid getting tangled in branches.**

**High-pressure hoses included.**

**High torque variable and adjustable motor.**

**Innovative oil cooling system: Cools the oil when running idle, resulting in a temperature reduction of 30 to 50°F.**

**Low rotor maintenance.**

		<b>HD-60SX</b>	<b>HD-70SY</b>	<b>HD-100DY2</b>
<b>Recommended Carrier Power</b>	HP (KW)	100 (75)	150 (112)	250 (190)
<b>Cutting Width</b>	IN (CM)	58.625 (149)	74.75 (190)	100 (254)
<b>Cutting Dist. from Ground Level</b>	IN (CM)	0.4 (1)	0.4 (1)	0.4 (1)
<b>Number of Hammers on Rotor</b>		34	46	60
<b>Optimal Target Material Diameter</b>	IN (CM)	8 (20)	10 (25)	24 (61)
<b>Exterior Length</b>	IN (CM)	43.42 (110)	49.5 (126)	49.6 (126)
<b>Exterior Height</b>	IN (CM)	56.1 (142)	59.4 (151)	59.4 (151)
<b>Exterior Width</b>	IN (CM)	72.56 (184)	94 (239)	119 (302)
<b>Rotor Diameter</b>	IN (CM)	16.25 (41.3)	18 (45.7)	18 (45.7)
<b>Approximate Typical Weight</b>	LBS (KG)	2,815 (1,277)	4,200 (1,910)	5,500 (2,495)

## HYDRAULICS

<b>Variable Displacement Axial Piston Motor</b>	CC	110	160	2 x 160
<b>Min. Required Continuous Flow</b>	GAL/MIN (L/MIN)	28 (106)	47 (178)	64 (242)
<b>Max. Allowed Continuous Flow</b>	GAL/MIN (L/MIN)	46 (174)	76 (288)	150 (568)
<b>Max. Operating Pressure</b>	PSI (BAR)	6,000 (410)	6,000 (410)	6,000 (410)
<b>Rotating Speed</b>	RPM	2,300	2,200	2,100

## FEATURES

<b>Hydraulic Push Bar</b>	N/A	Optional	Optional
<b>Door</b>	Optional	Optional	Optional
<b>Hydraulic Motor Option</b>	N/A	N/A	2 x 110 CC
<b>Bite Limiter Rotor</b>	Optional	N/A	N/A

This information is subject to change without notice.





## EXCAVATOR BITE LIMITER MULCHER

### VM SERIES

#### COUPLING

Shearex provides a standard attachment bracket to couple the mulcher to the carrier. Shearex is also able to custom-build a coupler for any carrier brand.



#### TILTING SYSTEM

Essential tool for facilitating the operator's work at height, allowing them easily visualize the rotor's trajectory.



#### OPTIONAL GRAPPLE SYSTEM

Move and sort through smaller material or pile them up for greater mulching control.



#### G2.0 BALANCING STANDARD ZERO VIBRATION ROTOR

We are the only mulcher manufacturer to adhere to the highest vibration standards in the market, the G2.0 Balancing quality. Optimal balance is crucial to minimize vibrations, premature bearing wear, and structural fatigue.



#### PROTECTION SYSTEM CONVEX DX™

Through our patented rotor configuration, the depth limiting rings are welded to both sides of the tooth holder, greatly increasing holder strength and durability. The ring geometry forces the material towards the center of the blade instead of just the edges, for less blade wear and long-lasting performance.



#### INCLUDED WITH ALL VM MODELS HYDRAULIC DOOR

The hydraulic door included on all VM models allows precise control of material flow, ensuring more efficient and consistent mulching.

IDEAL FOR

LAND-CLEARING AND FORESTRY CONTRACTORS, MUNICIPALITIES, AND UTILITY SERVICES / HYDRO / ROAD MAINTENANCE





**Poly-Chain® Carbon transmission belt.**

**Bolt-on liner made of Hardox® 500 for ultimate wear resistance. Easy maintenance and replacement.**

**Robust rotor design.**

**High torque variable and adjustable motor.**

**Innovative oil cooling system: Cools the oil when running idle, resulting in a temperature reduction of 30 to 50°F.**

		VM-25SK	VM-35SK	VM-40SL	VM-50SR	VM-60SR	VM-65SV
Excavator Size	T	5 to 8	6 to 12	12 to 15	15 to 20	20 to 25	25 to 40
Recommended Min. Carrier Power	HP (KW)	50 (37)	54 (40)	65 (48)	80 (59)	130 (96)	170 (127)
Cutting Width	IN (CM)	28 (70)	37 (95)	42 (107)	48 (123)	59 (149)	65 (165)
Cutting Dist. from Ground Level	IN (CM)	0.25 (0.64)	0.25 (0.64)	0.25 (0.64)	0.25 (0.64)	0.25 (0.64)	0.87 (2.2)
Number of Blades on Rotor		9	13	14	17	21	21
Optimal Target Material Dia.	IN (CM)	<5 (<13)	6 (15)	8 (20)	10 (25)	15 (40)	20 (50)
Door*		Hydraulic	Hydraulic	Hydraulic	Hydraulic	Hydraulic	Hydraulic
Exterior Length	IN (CM)	41 (104)	50 (127)	57 (145)	66 (168)	77 (194)	89 (225)
Exterior Height	IN (CM)	31 (77)	31 (77)	34 (85)	35 (89)	35 (89)	40 (102)
Exterior Width	IN (CM)	23 (58)	23 (58)	25 (65)	28 (71)	28 (71)	29 (74)
Rotor Diameter	IN (CM)	15 (38)	15 (38)	16 (41)	18 (45)	18 (45)	20 (50)
Approximate Weight	LBS (KG)	1,100 (499)	1,307 (593)	1,668 (757)	2,150 (975)	2,614 (1,188)	3,707 (1,681)

## HYDRAULICS

Variable Displacement Axial Piston Motor	CC	28	60	80	110	110	160
Min. Required Continuous Flow	GAL/MIN (L/MIN)	15 (57)	23 (87)	30 (114)	42 (159)	42 (159)	51 (193)
Max. Required Continuous Flow	GAL/MIN (L/MIN)	22 (83)	38 (144)	44 (167)	63 (238)	63 (238)	91 (344)
Max. Operating Pressure	PSI (BAR)	6,000 (410)	6,000 (410)	6,000 (410)	6,000 (410)	6,000 (410)	6,000 (410)
Rotating Speed	RPM	3,800	3,500	3,500	3,000	3,000	3,000

## FEATURES

Tilt*	Optional	Optional	Optional	Optional	Optional	Optional
Grapple*	-	Optional	Included	Included	Included	Included
Heel	Optional	Optional	Optional	Optional	Optional	Optional

**\*Door** - Requires 1 auxiliary hydraulic line (pressure + return) and 1 case drain. A diverter valve is included for door control. Electrical power (12V or 24V) must be supplied by the machine; wiring is included.

**\*Tilt** - A second double auxiliary hydraulic line is strongly recommended to allow lower pressure settings. Operation with a double diverter valve is possible but not recommended.

**\*Grapple** - Combination of tilt and grapple: Requires 2 double auxiliary hydraulic lines plus a case drain. Use of a triple diverter valve is not recommended due to poor performance.

This information is subject to change without notice.





# COMPACT EXCAVATOR LIGHT DUTY BITE LIMITER MULCHER

## VL SERIES

Shearex's Light Duty Bite Limiter Mulcher attachment is the ultimate tool for fast and efficient roadside maintenance, invasive species removal, land clearing, and underbrush maintenance. Every VL mulcher comes with a customer kit packed with essentials to get you up and running.



		VL-20SC	VL-30SC	VL-40SC
Excavator Size	T	2 to 4	3 to 7	6 to 10
Recommended Min. Carrier Power	HP (KW)	20 (15)	30 (23)	47 (35)
Cutting Width	IN (CM)	21.25 (54)	31 (78)	40 (101)
Cutting Distance From Ground Level	IN (CM)	0.25 (0.64)	0.25 (0.64)	0.25 (0.64)
Number of Blades on Rotor		8	12	16
Optimal Target Material Diameter	IN (CM)	<3 (<75)	<4 (<10)	<5 (<12)
Floating Door		Mechanical	Mechanical	Mechanical
Exterior Length	IN (CM)	32.5 (83)	42 (107)	51 (129)
Exterior Height	IN (CM)	22.75 (58)	22.75 (58)	22.75 (58)
Exterior Width	IN (CM)	18 (45)	18 (45)	18 (45)
Rotor Diameter	IN (CM)	13 (33)	13 (33)	13 (33)
Approximate Weight	LBS (KG)	430 (195)	550 (249)	735 (334)

## HYDRAULICS

Fixed Axial Piston Motor	CC	12 (18 optional)	18	32
Min. Required Continuous Flow	GAL/MIN (L/MIN)	8 (30)	13 (49)	22 (83)
Max. Required Continuous Flow	GAL/MIN (L/MIN)	18 (68)	18 (68)	34 (129)
Max. Operating Pressure	PSI (BAR)	5,800 (400)	5,800 (400)	5,800 (400)
Rotating Speed	RPM	3,500	3,500	3,500
Pulley Ratio		1:1	1:1	1:1
Pressure Line I.D.	# (IN)	#10 (0.625)	#10 (0.625)	#12 (0.75)
Return Line I.D.	# (IN)	#10 (0.625)	#10 (0.625)	#12 (0.75)
Drain Line I.D.	# (IN)	-	-	-

## FEATURES

Tilt	-	-	-
Grapple	-	-	Optional
Heel	Optional	Optional	Optional

This information is subject to change without notice.

### IDEAL FOR

OCCASIONAL LAND CLEARING OPERATIONS, INVASIVE SPECIES REMOVAL AND ROAD MAINTENANCE.









## SHEAREX MULCHER STARTUP SERVICE

At Shearex, we're dedicated to ensuring your mulcher delivers top performance from day one. That's why every new mulcher purchase comes with our comprehensive Startup Service\* at no additional cost. Our expert technicians will travel to your site—to fine-tune the mulcher to your carrier for maximum efficiency.

We also provide a quick training session on proper maintenance techniques, helping you extend the lifespan of your equipment.

With Shearex, you get more than just a mulcher—you get unmatched support for optimal results.

\*The Startup Service is not included with the VL Series.



### INCLUDED WITH ALL VM & HM MULCHERS **CUSTOMER KIT**

Shearex offers a customer kit with every VM & HM Series mulcher purchase, including spare blades, hardware and a battery-powered grinder to sharpen your blades.



### INCLUDED WITH ALL VL MULCHERS **COMPLIMENTARY KIT**

Every VL mulcher comes with a complimentary kit packed with essentials to get you up and running.

- Eight blades (bolts included)
- One tube of grease
- Shearex cap
- User manual
- Sharpening guide

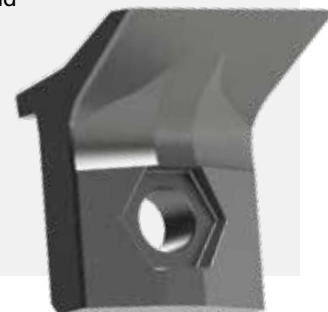

# BLADE TYPES

Depending on your operation, choose between our different blade types when ordering your mulcher to provide maximum durability to your equipment.

## BITE LIMITER SHARP TEETH

Our advanced **cutting blades** are available for all your land clearing and forestry applications in regions with fine textured soils where high efficiency is key. Offered in both standard and high abrasion resistant materials, ensuring Shearex has the perfect pairing for your application. Choose between Type 10 or Type 20 blades.

### TYPE 10 BLADES

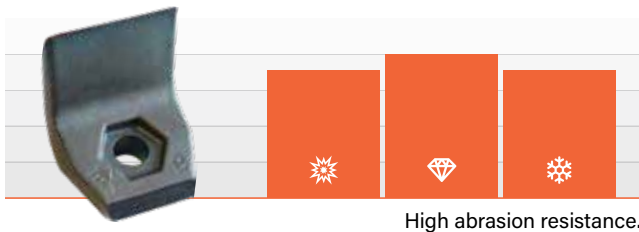

High abrasion resistance.

### TYPE 20 BLADES

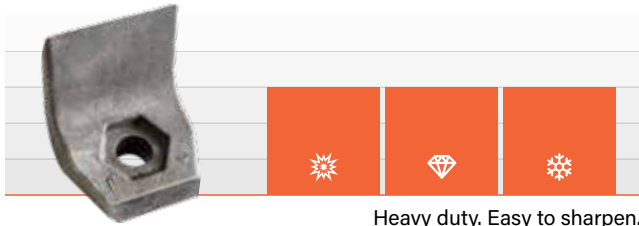

Heavy duty. Easy to sharpen.  
High impact resistance.

### TYPE 20 BLADES - LIGHT DUTY MULCHER

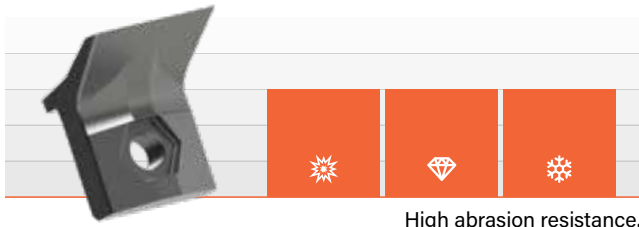

High abrasion resistance.

## SOLID DRUM HAMMERS

The HD Series solid drum mulcher is comprised of **central** and **lateral carbide blades**, for optimal performance and durability. High-resistance hammers are located on both ends of the rotor to maximise your mulching operations.

### CENTRAL HAMMERS (HD SERIES ONLY)

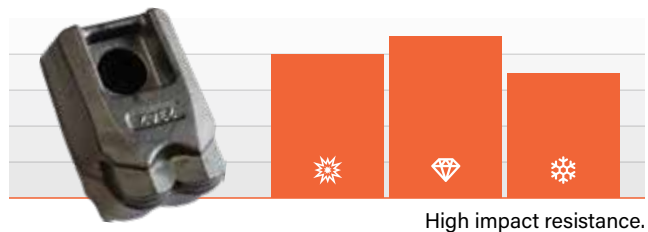

High impact resistance.

### LATERAL HAMMERS (HD SERIES ONLY)



High impact resistance.  
High resistance edges.

## BITE LIMITER CARBIDE TEETH

Shearex **carbide blades** are available for all of your land clearing operations. Choose these blades for land clearing near roads, where asphalt parts can be found, or in fields where the ground could be more rocky. These blades provide groundbreaking durability to your equipment.

### CARBIDE BLADES

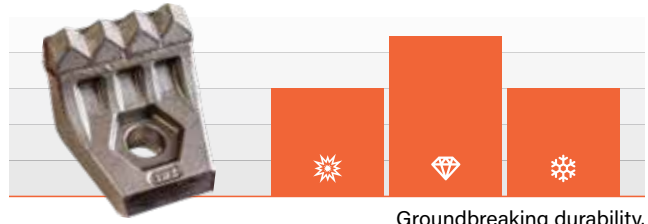

Groundbreaking durability.



IMPACT RESISTANCE



ABRASION RESISTANCE



COLD RESISTANCE







# **LAND CLEARING ATTACHMENTS**





# HARVESTER SHEAR

## FHS SERIES

Finish your land clearing jobs in-depth by uprooting and cutting roots, stumps, and biomass beyond the reach of your other land clearing tools.

### LOW MAINTENANCE

### EXTREME CUTTING FORCE

### HIGH QUALITY STEEL

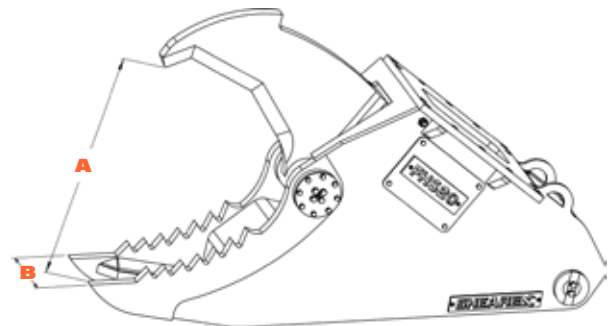

MODEL	CARRIER SIZE T	WEIGHT LBS (KG)	OPENING IN (MM) A	WIDTH IN (MM) B	DEPTH IN (MM)	PRESSURE PSI (BAR)	FORCE T
FHS20	15-25	2,760 (1,255)	39 (990)	15 (400)	28 (711)	5,000 (350)	30
FHS30	25-35	5,650 (2,568)	55 (1,400)	18 (457)	37 (940)	5,000 (350)	45

This information is subject to change without notice.





# STUMP SHEAR

## SS SERIES

The Shearex stump shear is perfect for land clearing, designed to uproot, break down, and split large stumps into manageable pieces for shredding. Tackle tough stumps efficiently and finish your job in-depth with ease.

### EASY MAINTENANCE

### POWERFUL GRIP

### AVAILABLE IN HYDRAULIC OR MECHANICAL CONFIGURATIONS

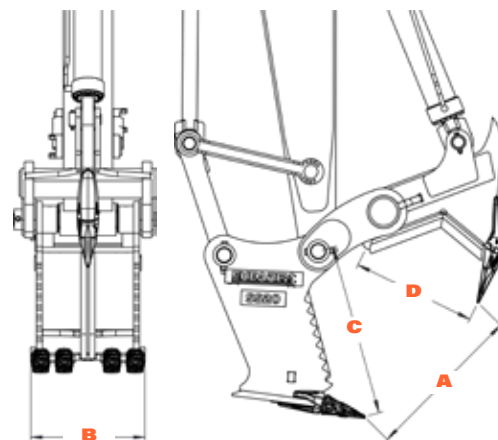

MODEL	CARRIER T	WEIGHT LBS (KG)	OPENING IN (MM) A	WIDTH IN (MM) B	TIP RADIUS IN (MM) C	CUT LENGTH IN (MM) D	MECHANICAL CONFIG.
SS16	12-16	2,315 (1,050)	52 (1,321)	22 (559)	32 (813)	21 (533)	Available
SS20	15-24	2,811 (1,275)	58 (1,473)	25 (635)	34 (864)	24 (610)	Available
SS27	18-25	3,858 (1,750)	64 (1,626)	30 (762)	42 (1,067)	30 (762)	Available
SS30	25-38	5,512 (2,500)	68 (1,727)	30 (762)	43 (1,092)	31 (787)	Available
SS40	30-50	7,716 (3,500)	72 (1,828)	32 (813)	48 (1,219)	34 (864)	Available

This information is subject to change without notice.





# BRUSH GRAPPLE

## BG SERIES

Introducing the Brush Grapple by Shearex, a powerful and versatile tool designed to excel in forestry, recycling, scrap yards, construction, agriculture, and storm cleanup applications. Featuring an open-end design, it allows you to handle a wide range of materials, from logs and brush to roots and bulky debris. With twin hydraulic cylinder grapple arms protected by guards and operating under 3000 PSI of pressure, this attachment provides exceptional heavy-duty capacity for any job.

### PROTECTED CYLINDERS

### 3000 PSI CYLINDER DOUBLE GRAPPLE

### HYDRAULIC HOSE GUARD

### UNIVERSAL SKID STEER ATTACHMENT

#### SPECIFICATIONS

		BG-60	BG-72	BG-83HD
Overall Width	IN	60	72	83
Grapple Open Height	IN	38	38	37
Grapple Closed Height	IN	16.75	16.75	16
Overall Depth	IN	39	39	36
Weight	LBS	750	825	1,150
Number of Tines		9	11	16
Tine Spacing	IN	7	6.75	5



This information is subject to change without notice.

# STUMP GRINDER

## SG SERIES

The Shearex stump grinder has been designed for maximum efficiency, unrivaled speed and minimal impact on the environment. With Shearex, no time is wasted on clean-up: our stump grinder quickly pulverizes stumps and buried residues, leaving your work sites clean and ready for new planting or maintenance vehicle traffic.

Blade system interchangeable **in less than 5 minutes**.

Adapt your equipment to different applications and **soft or hardwood**.

Equipped with a high-performance, **low-maintenance motor** guaranteeing constant, reliable power every time.

Designed to **minimize downtime and maximize productivity** in the field.

Our **advanced technology and Hardox® 500 blades** will ensure you meet the demands of the toughest jobs, while respecting the environment.

**Rapid availability of wear and replacement parts:** You don't have to worry about long waiting times - everything you need is at hand to keep your equipment up and running.



### AVAILABLE BLADE TYPES



Standard  
Straight  
Blades



Notched  
Blades

SPECIFICATIONS		SG15	SG24	SG34
Carrier Size	T	3-6	6-14	12-30
Cut Diameter	IN (MM)	15 (380)	24 (600)	34 (860)
Maximum Pressure	PSI (BAR)	5,500 (379)	5,500 (379)	5,500 (379)
Maximum Hydraulic Flow	GAL/MIN (L/M)	10-25 (38-100)	14-35 (62-145)	22-50 (100-225)
Minimum Speed	RPM	50	35	35
Maximum Speed	RPM	110	60	50
Maximum Torque*	FT-LBS (Nm)	10,500 (14,250)	13,000 (17,000)	32,000 (45,000)
Cone Splitter Diameter (Optional)	IN	14	16	16

This information is subject to change without notice. \* Maximum torque may vary depending on maximal pressure.



# MINI TREE SHEAR

## FTS SERIES

The Shearex mini tree shear is a natural choice for those who seek to cut down a whole tree in a matter of seconds. Its powerful replaceable cutting blade makes it the best product for rapidly cutting and moving whole trees for other specialised units to transport and process. The Shearex mini tree shear is an effective and easy way to jumpstart your forestry production output.



### SHEAR TREES UP TO 7" DIAMETER

### POWERFUL GRIP & CUT

### EASY MAINTENANCE

### ACCUMULATOR INCLUDED

	CARRIER SIZE T	WEIGHT LBS (KG)	OPENING IN (MM)	GRAPPLING IN (MM)	HEIGHT IN (MM)	FORCE T	PRESSURE PSI (BAR)	HYD. FLOW GAL/MIN (L/MIN)
FTS07	5-9	950 (431)	35 (889)	35 (889)	24 (609)	11	3,191 (220)	13-15 (50-60)

This information is subject to change without notice.

# WOOD CONE SPLITTER

## SC SERIES

Split your logs with power and ease. The Shearex wood cone splitter will handle a large amount of workload very fast! Its robust design with replaceable tips will increase your productivity by splitting your bigger logs, stumps and roots with this splitter before sending it into your shredding equipment.



### IMPRESSIVE SPLITTING POWER

### REPLACABLE TIP

### EASY MAINTENANCE

### IDEAL FOR FORESTRY

SPECIFICATIONS		SC15	SC34
Carrier Size	T	3 to 9	10 to 30
Weight	LBS (KG)	700 (318)	1,650 (750)
Cone Diameter	IN (MM)	13.5 (343)	15.5 (394)
Height	IN (MM)	22 (559)	25 (635)
Pressure	PSI (BAR)	5,000 (350)	5,000 (350)
Hyd. Flow	GAL/MIN (L/MIN)	10-25 (38-100)	20-50 (75-190)
Torque	FT-LBS (NM)	10,500 (15,500)	10,500 (15,500)
Stump Grinder		Optional	Optional

This information is subject to change without notice.







**1-579-213-0350 - INFO@SHEAREX.CA**

---

**FOLLOW US**     



**SHEAREX.COM**

SH-CA-ALL\_PRODUCT-E-26-02